

ATTACHMENT B SERVICE AREA AND CURRENT COLLECTION DAYS

SOLID WASTE

**Food Waste
Wet Garbage**

- Bag It
- Keep the lids closed



Weekly **SOLID (Garbage)** Waste Days

AREA 3	AREA 2	AREA 1
Wed. and Sat.	Tues. and Friday	Mon. and Thurs.

**Solid Waste (Garbage)
Collection Guidelines**

- Solid Waste is collected twice (2) per week based on your location.
- Do not place your waste out for collection more than 48 hours in advance of pickup
- Solid waste must be placed curbside before 7 a.m. on day of pickup
- All empty containers must be removed from swale that day.
- All Solid waste must be placed in tied plastic bags and placed in a waste can.
- Waste cans and bags must weigh less than 50 pounds each.
- Waste cans must be 40 gallons or smaller, with handles and a lid.
- Loose items will not be collected
- Horse manure will not be collected.
- Containers larger than 40 gallons in size cannot be used as waste containers.
- No collection will take place under hurricane warnings.

RECYCLABLES

- All paper products
- Cardboard
- Glass Bottles
- All plastic products
- Metal Cans /Tin
- Aluminum
- Newspaper



RECYCLING Collection Service Days

AREA 3	AREA 2	AREA 1
Wednesday	Tuesday	Monday

Recycling Collection Guidelines

All recycling collection is single stream collection. All recycled materials go into the same container. Recycling is collected once a week according to your area.

- Paper
- newspaper
- catalogs
- cereal boxes
- cardboard products
- plastic containers
- metals
- glass

Can all be mixed together in the one recycling container that is provided.

- No corrugated boxes or lids allowed
- Please rinse your containers

Code Violations and Non –conforming handling of waste include:

- Any Solid Waste or Bulk Waste that is inappropriate or co-mingled.
- Exceeds twelve (12) cubic yard combined maximum.
- Waste placed out earlier than the Saturday before Collection day.



BULK Collection Service Dates By Area

	AREA 3	AREA 2	AREA 1
	Wednesday Only	Tuesday Only	Monday Only
Oct -15	10/12/15 10/26/15	10/13/15 10/27/15	10/14/15 10/28/15
Nov -15	11/9/15 11/23/15	11/10/15 11/24/15	11/11/15 11/25/15
Dec -15	12/7/15 12/21/15	12/8/15 12/21/15	12/9/15 12/23/15
Jan -16	1/6/16 1/20/16	1/5/16 1/19/16	1/4/16 1/18/16
Feb -16	2/3/16 2/17/16	2/2/16 2/16/16	2/1/16 2/15/16 2/29/16
Mar -16	3/2/16 3/16/16 3/30/16	3/1/16 3/15/16 3/29/16	3/14/16 3/28/16
Apr -16	4/3/16 4/27/16	4/12/16 4/26/16	4/11/16 4/25/16
May -16	5/11/16 5/25/16	5/10/16 5/24/16	5/9/16 5/23/16
Jun -16	6/8/16 6/22/16	6/7/16 6/21/16	6/6/16 6/20/16
Jul -16	7/6/16 7/20/16	7/5/16 7/19/16	7/4/16 7/18/16
Aug -16	8/3/16 8/17/16 8/31/16	8/2/16 8/16/16 8/30/16	8/1/16 8/15/16 8/29/16
Sep -16	9/14/16 9/28/16	9/13/16 9/27/16	9/12/16 9/26/16
Oct -16	10/12/16 10/26/16	10/11/16 11/25/16	10/10/16 10/24/16
Nov -16	11/9/16 11/23/16	11/8/16 11/22/16	11/7/16 11/21/16
Dec -16	12/7/16 12/21/16	12/6/16 12/20/16	12/5/16 12/19/16

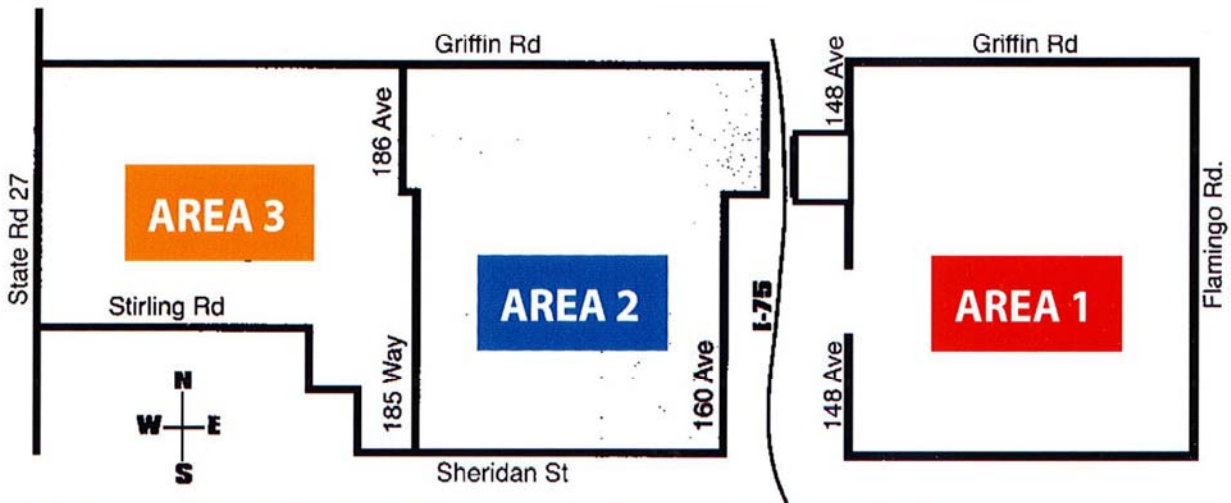

Bulk Trash Includes waste that is generated from the ordinary housekeeping operations of a residential unit. Bulk waste must be generated by the customer at the residential unit where it is being collected. BULK YARD TRASH does not include any contractor or landscaper generated waste, exempt waste or storm debris. BULK TRASH may be placed out for pickup on the Saturday prior to your scheduled service date and is limited to 12 cubic yards. Debris generated by a contractor, landscaper or nursery at a residential unit will not be picked up.

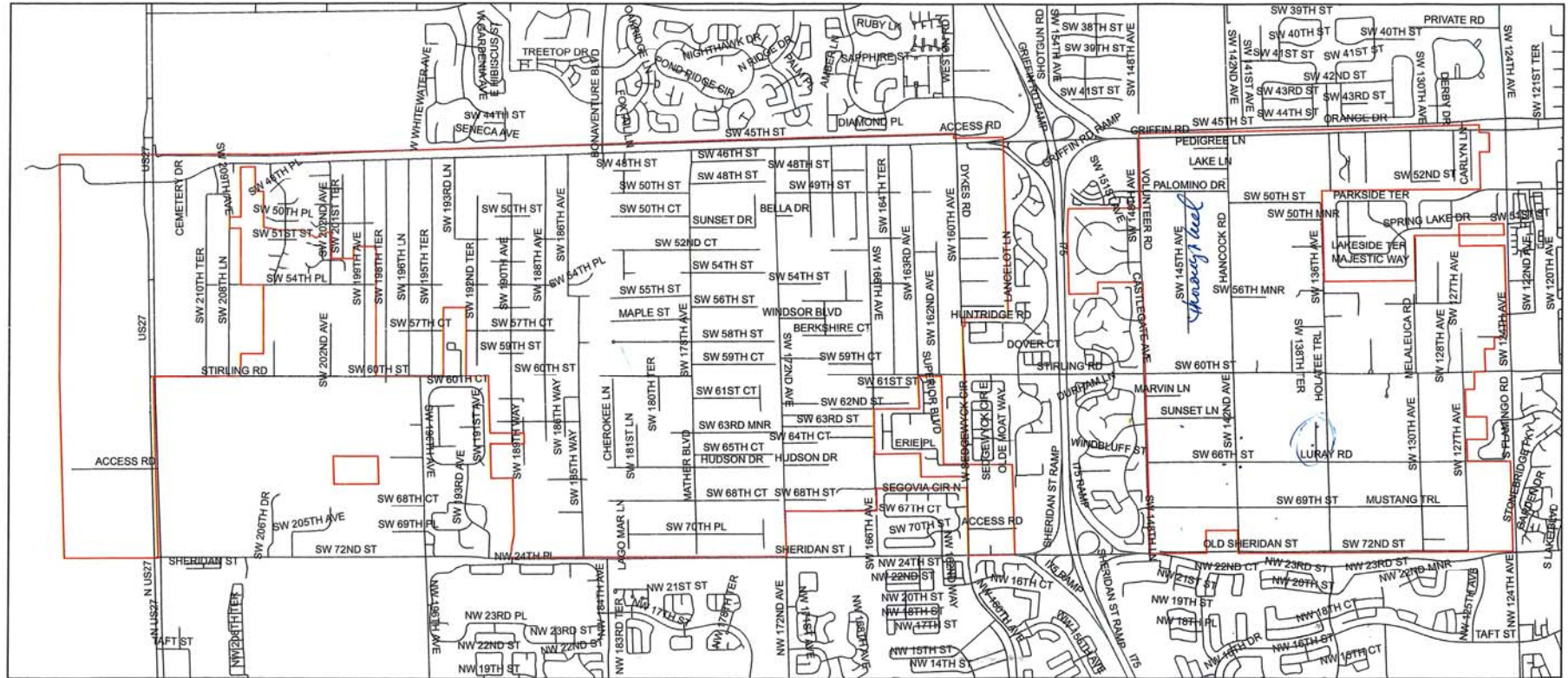

Legend
Southwest Ranches Boundary

